

I-91 S/B Exits 40-39

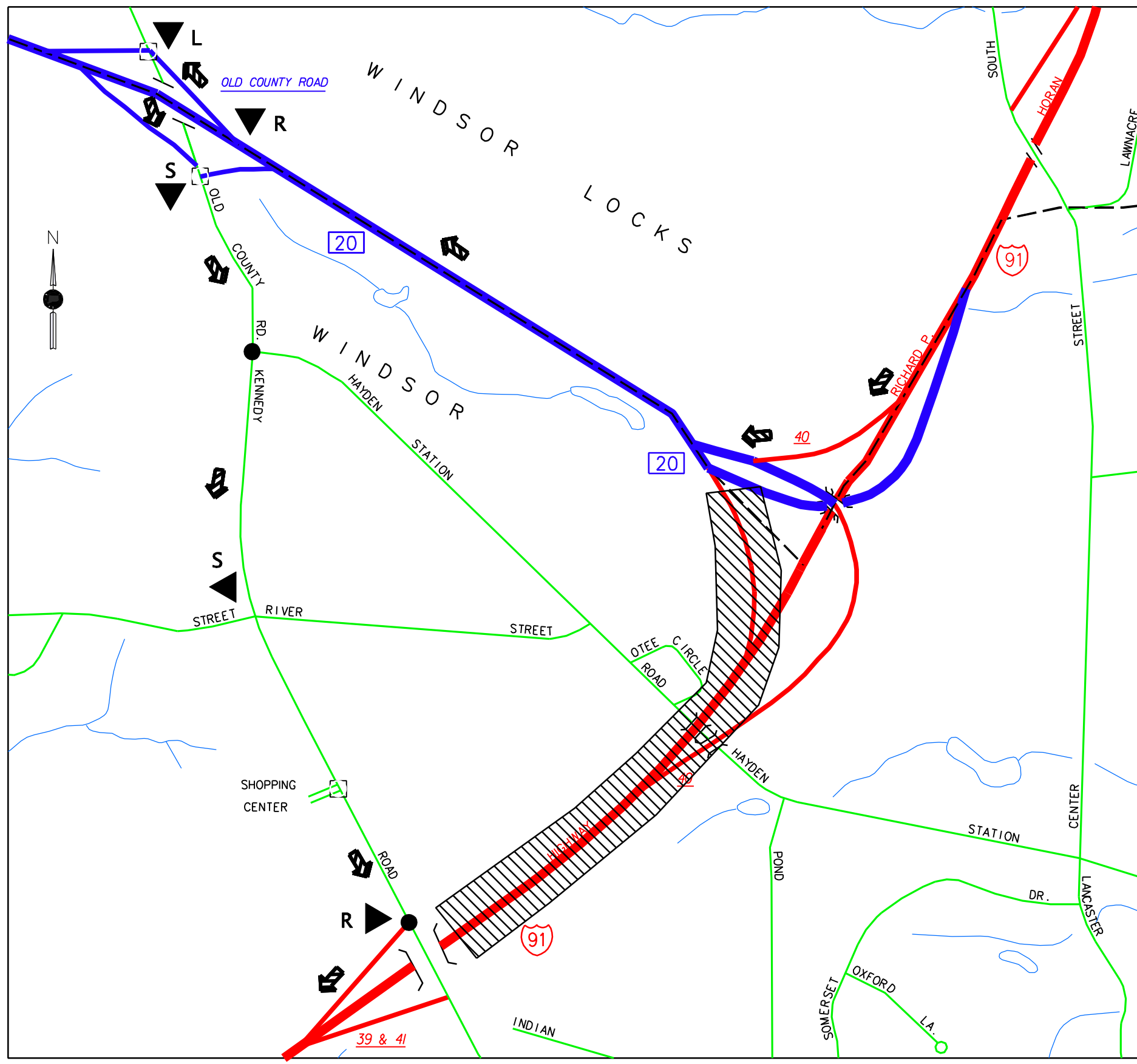

WINDSOR

Date	Rev. Date
08/13/97	10/20/97

PRIMARY ROUTE

Exit 40 (RT 20), RT 20 westerly to Old County Road exit, Left on Old County Road to Kennedy Road southerly back to I-91 S/B on ramp.

SECONDARY ROUTE

SPECIAL REQUIREMENTS

1.) Police Monitor Locations (2) – on/off ramps to Old County Rd.

LEGEND

- CLOSURE LOCATION
- TRUCK ROUTING
- CAR ROUTING
- ALL VEHICLE ROUTING
- SIGNAL
- POLICE MONITOR - SIGNAL
- POLICE MONITOR NO SIGNAL
- DIVERSION ROUTE SIGN LOCATIONS
- TRUCK ONLY DIVERSION ROUTE SIGN LOCATIONS

EMERGENCY CONTACTS

STATE POLICE
TROOP - H (860) 534-1000
D.E.P. 860-566-3338
D.O.T. 1-800-695-0444

WINDSOR
POLICE DEPT. (860) 688-3641
POLICE FAX # (860) 683-2862
FIRE DEPT. (860) 688-5273

ADJACENT TOWN INFO
WINDSOR LOCKS P. D.
(860) 627-1461

DIVERSION SIGNS REQUIRED

0	Left Arrow	1
0	Right Arrow	2
0	Straight Arrow	2
0	Total Signs	5

SIGNAL SYSTEM CONTACT -